

ISC-1210U-I / 1310U-I

► Industrial USB to Serial Media Converter with Isolation

Features

- Fully compliant with USB specification 1.1
- Support Full-Duplex transmission for RS-232/RS-422
- RS-232/RS-422 support RTS/CTS handshake signals
- Transient suppression on RS-485 data lines
- Auto detect and switching for USB to RS-232/422/485
- Auto detect and switching baud rate up to 115.2Kbps
- USB bus powered with ultra low power consumption
- DIN-Rail and wall mounting enabled



Introduction

The ISC-1210U-I / ISC-1310U-I converter is an intelligent, stackable expansion module that connects to a PC USB port or USB Hub via the Universal Serial Bus(USB) port, providing one High-Speed RS-232/RS-422 or RS-485 serial port(jumper-less). The ISC-1210U-I / ISC-1310U-I features easy connectivity for traditional serial devices. The RS-232 standard supports full-duplex communication and handshaking signals (such as RTS, CTS) and The RS-485 control is completely transparent to the user and software written for half-duplex operation without any modification. The ISC-1210U-I / ISC-1310U-I's opto-isolators provide 3000 VDC of isolation to protect the host computer from destructive voltage spikes on the RS-232/RS-422 and RS-485 data lines. ISC-1210U-I / ISC-1310U-I also offer internal surge-protection on their data lines. The internal high-speed transient suppressors on each data line protect the modules from dangerous voltages levels or spikes. In addition, the ISC-1210U-I / ISC-1310U-I module derives the power from USB port and doesn't need any aid of external power adapter.



Connections of USB to Serial Media Converter

Dimension

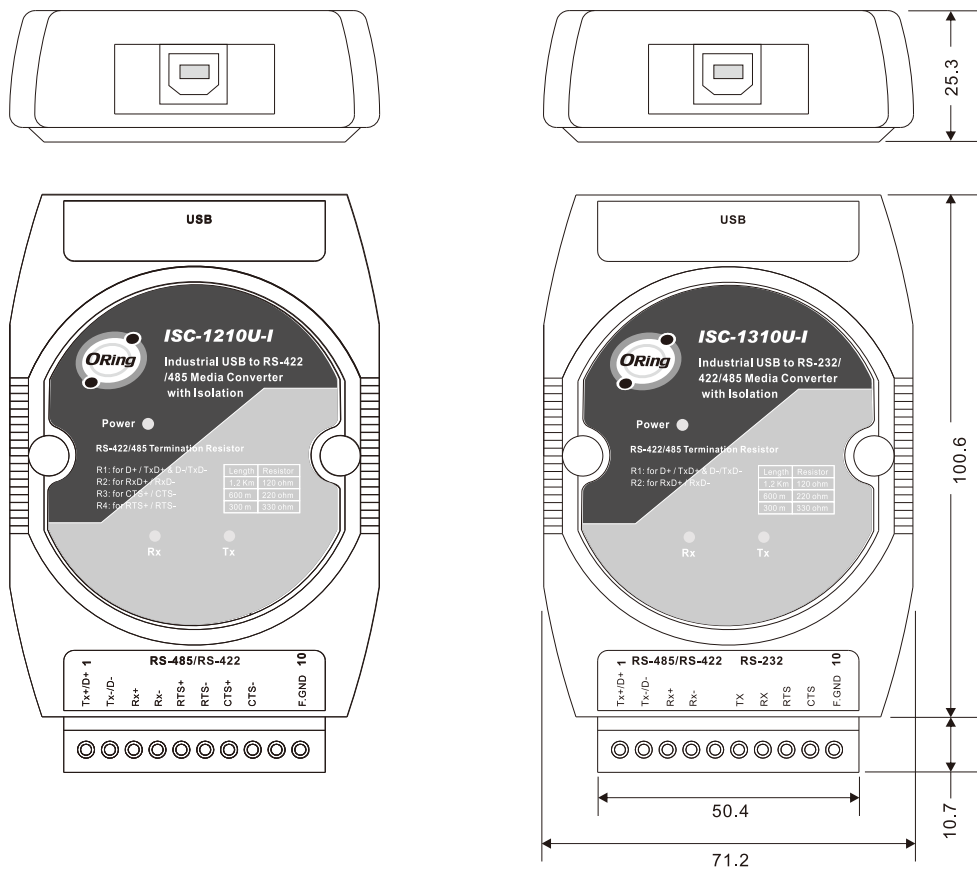

(Unit=mm)

Specifications

ORing Media Converter Model	ISC-1210U-I	ISC-1310U-I
Physical Ports		
USB V1.1 Port	1	1
Serial Port	RS-422/485	RS-232/422/485
Serial Connector	10-pin terminal block	
Baud Rate	300 to 115.2Kbps	
Signals	RS-422 : TX+, TX-, RX+, RX-, RTS+, RTS-, CTS+, CTS- RS-485 : Data+, Data-	RS-232 : TX, RX, RTS, CTS, GND RS-422 : TX+, TX-, RX+, RX- RS-485 : Data+, Data-
LED Indicators		
Power Indicator	Green : Power LED x 1	
TxD Indicator	Green LED x 1	
RxD Indicator	Red LED x 1	
Power		
Input Power	From USB bus power (self power)	
Power Consumption (Typ.)	0.65 Watts	

Protection	
Isolation	3000 VDC
Driver Support	
O.S.	Windows 95/98/ME/2000/XP, Linux
Physical Characteristic	
Enclosure	IP-30
Dimension (W x D x H)	71.2(W) x 25.3(D) x 100.6(H) mm (2.8x1x3.96 inch.)
Weight (g)	130g
Environmental	
Storage Temperature	-25 to 85°C (-13 to 185°F)
Operating Temperature	-10 to 70°C (14 to 158°F)
Operating Humidity	5% to 95% Non-condensing
Regulatory approvals	
EMI	FCC Part 15, CISPR (EN55022) class A
EMS	EN61000-4-2 (ESD), EN61000-4-3 (RS), EN61000-4-4 (EFT), EN61000-4-5 (Surge), EN61000-4-6 (CS), EN61000-4-8, EN61000-4-11
Shock	IEC60068-2-27
Free Fall	IEC60068-2-32
Vibration	IEC60068-2-6
Warranty	2 years

Ordering Information

ISC-**A****B****C****D****E**-**F**

Code Definition	Serial Port Number	Port Type	Converter Prot Number	Converter Type	Other Type	Additional Function
Option	- 1 : 1 port	- 1 : RS-232 - 2 : RS-422/485 - 3 : RS-232/422/485	- 1 : 1 port	- 0 : other type - 1 : RS-232 - 2 : RS-422/485 - 3 : RS-232/422/485	- F : 100Base-FX Fiber - U : USB	- I : Isolation

	Model Name	Description
Available Model	ISC-1210U-I	Industrial 1-port USB to 1-port RS-422/485 serial media converter with 3KV isolation
	ISC-1310U-I	Industrial 1-port USB to 1-port RS-232/422/485 serial media converter with 3KV isolation

Packing List

- ISC-1210U-I/1310U-I
- ORing Tool CD
- Quick Installation Guide
- DIN-Rail Kit
- Wall-mount Kit
- USB Cable